

System

GYPCORK Protect



**Board with high protection
against moisture and fire,
and excellent thermal and
acoustic insulation**



system **GYPCORK** Protect

Recommended as a solution for façades or for interior applications in wet areas



The new **GYPCORK Protect** raises performance to a new level by incorporating the high-performance **Gyptec Protect gypsum board**, developed to meet more demanding technical requirements, such as façade applications or interior use in wet areas, due to its mechanical strength and resistance to moisture and fire.

GYPTEC PROTECT BOARD + ICB

Composite board consisting of **Protect gypsum board** type GM-F, H1, I, R combined with **expanded cork agglomerate insulation (ICB)**. A product that combines the properties of the Gyptec Protect board with the excellent insulation performance of expanded cork agglomerate from Amorim Cork Solutions.

- Moisture resistant
- Fire resistant
- High mechanical strength
- High thermal and acoustic performance

Solution for **exterior or interior applications**, recommended where the use of **traditional gypsum boards is not advised**. Its application in systems with metal framing helps to minimize thermal bridging through profiles.



GYPCORK PROTECT SOLUTION

Reference	ICB 13PROTECT-40	ICB 13PROTECT-60
Thickness (± 0,5 mm)	52,5	72,5
Width (± 12 mm)	1200	1200
Length (± 12 mm)	2000	2000
Approximate Weight (± 5% kg/m ²)	15,4	17,6
Flexural Strength Longitudinal/Transversal (N)>	725/300	725/300
Thermal Resistance (m ² .K/W)	1,07	1,58

Two-in-one solution combining lining and insulation, simplifying on-site application and saving time and resources



Recommended for exterior or interior applications requiring **high resistance to moisture and fire** (A1 classification), **high energy efficiency**, and where the use of traditional gypsum boards is not recommended.

For example: dry construction solutions for **façades** in new builds, refurbishment or modular construction (**reinforced base coat and ETICS systems**), as well as interior solutions for **dry areas with A1 fire reaction requirements**, wet areas, or wet areas with ceramic finishes.



Board Classification

Type GM-F, H1, I, R / Type H1 (EN15283-1)

Facing paper: Green

Water vapour resistance factor (μ): 26 (EN 12524)

Reaction to fire: A1

Longitudinal edge: Tapered (BA)

Edge depth: 1,5 mm [0,6-2,5 mm]

Edge width: 60 mm [40-80 mm]

Transversal edge: Square (BQ)

ICB thermal conductivity: 0,039 W/m.K

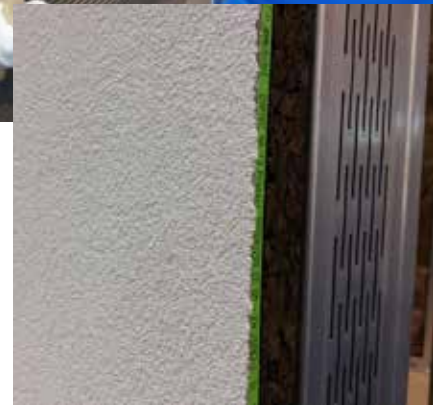
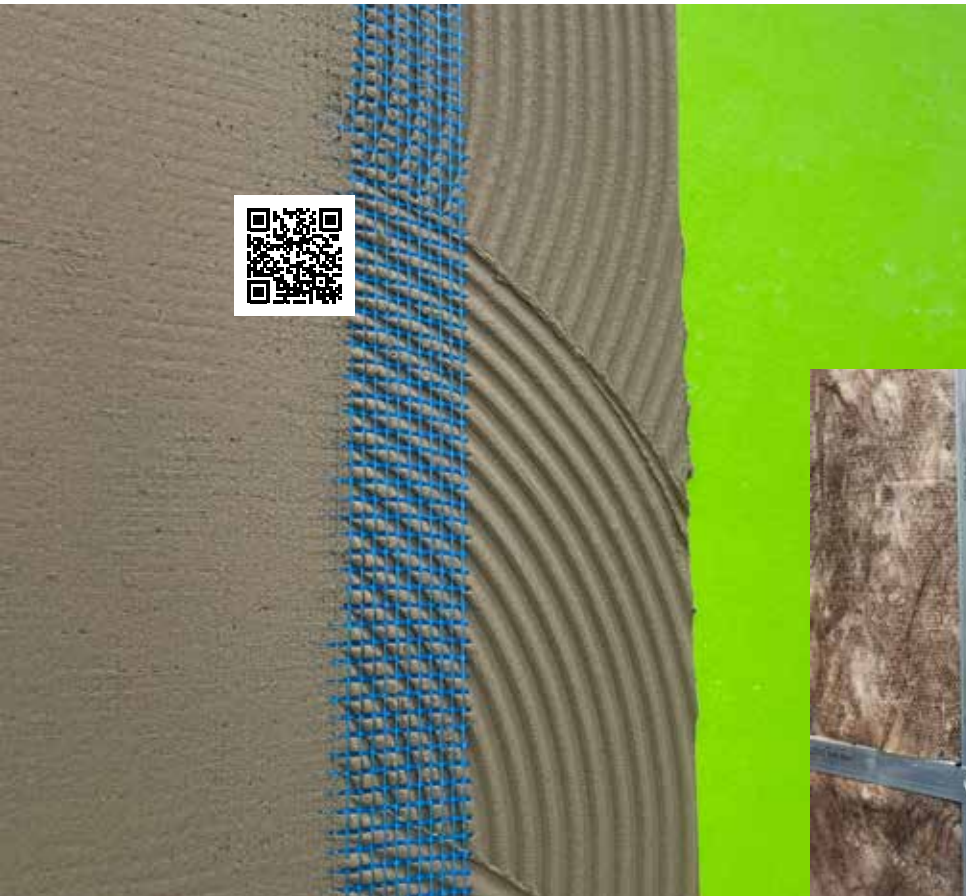

GYPCORK PROTECT
INTEGRATES THE
SYSTEM



SKINIUM
THE WALL SYSTEM

THE NEW SKIN OF BUILDINGS.
A COMPLETE CONSTRUCTION
SYSTEM FOR EXTERNAL
FAÇADES.

system

GYPCORK Protect



DOC 04.02-009 REV00
startupdesign.pt

PROVEN QUALITY

Material characteristics are regularly tested, promoting continuous improvement of quality parameters and allowing the best solutions to be delivered to customers.

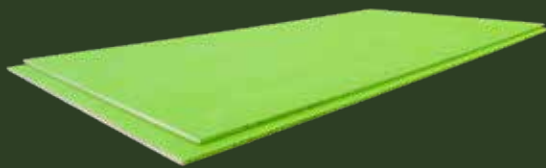

GYPTec PROTECT GYPSUM BOARD

All products bearing the Gyptec brand or name guarantee quality and technical excellence in their intended applications and are periodically subjected to rigorous testing and trials. Through continuous innovation and ongoing improvement of products and production methods, the company remains committed to its vision of being a reference brand in this market.

Main characteristics

- Acoustic insulation
- Low thermal conductivity
- Moisture regulation
- Non-combustible and effective in fire barrier systems
- Durable and impact resistant
- Versatile and adaptable to all types of finishes
- Recyclable

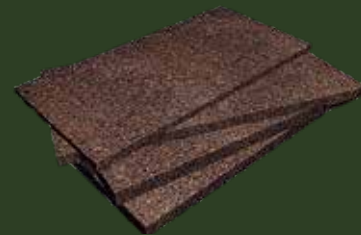

EXPANDED CORK AGGLOMERATE

Expanded Cork Agglomerate (ICB - Insulation Cork Board) is a 100% ecological and recyclable product, derived from a renewable raw material, as cork extraction is part of the cork oak's natural life cycle.

Its production uses only cork granules which, when subjected to a thermal process, release a natural resin called suberin, acting as a natural binder.

Main characteristics

- Thermal conductivity from 0.036 to 0.040 W/m²·°C
- Excellent acoustic insulation
- Natural and ecological insulation
- Good fire behaviour / does not release toxic gases
- Recyclable
- Not affected by rodents



Parque Ind. e Emp. da Figueira da Foz
Lote 3 - S. Pedro
3090-380 Figueira da Foz - Portugal
T (+351) 233 403 050 - F (+351) 233 430 126
geral@gyptec.eu - www.gyptec.eu



R. Comendador Américo Ferreira Amorim, 260
4535-186 Mozelos, Portugal
T: +351 227 475 300
geral.acs@amorim.com
www.amorimcorksolutions.com